

Fuel Parts

Adjustable Fuel Pressure Regulator !

No.	Application		Part no.	Code	Price with tax	Price	Fuel line connection		Connector part no.	Attachment method
							In	Out		
①	Silvia	PS13 (SR20DET)	22670-RR580	B	13,860	13,200	Direct connection with fuel line, O-ring seal	Rubber hose connection	Not required	Direct connection with fuel line, O-ring seal
	180SX	RPS13 (SR20DET)								
	Skyline	ECR33 (RB25DET)								
	Skyline GT-R	BNR32 (RB26DETT)								
		BCNR33 (RB26DETT)								
Stagea 260RS	WGN34 (RB26DETT)									
②	General-Purpose type (Installation pitch : 32mm)		22670-RR710	B	13,860	13,200	Rubber hose connection	Rubber hose connection	22672-RR710 (φ 8.0 pipe type)	Match with bracket from body; attach
③	General-Purpose type (Installation pitch : 32mm)		22670-RR711	B	15,750	15,000	AN6 screw connector	AN6 screw connector	22672-RR711 (#6 fitting)	Match with bracket from body; attach

Features

Based on originally equipped light & small regulator, fuel pressure adjustment function is added. Adjustment range and relief ability is equal to that of standard regular sized type. By controlling fuel pressure, the most suitable setting can be made for the injector to deliver the best jetting performance.

Specifications

- Fuel pressure adjustment range: 196-588kPa (flow volume 40L/h, 2 to 6kgf/cm²)
- Diaphragm diameter: φ36.5
- Operating temperatures: -30 to 120 °C
- Pressure slope: 157x10kPa/L/h
- Anti-vibration resistance: 250m/sec

Product Note !

Resetting to match the engine control unit will be required.

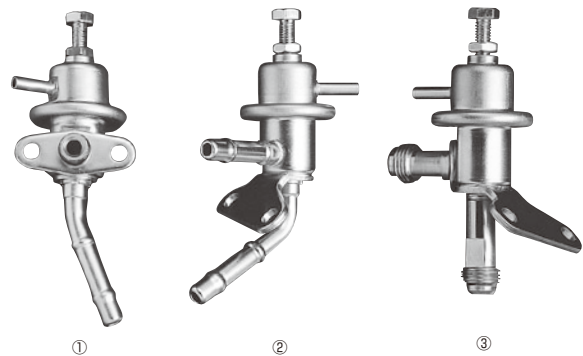

Connector and hose for NISMO variable fuel pressure regulator (general-purpose type)

No.	Part	Part no.	Code	Price with tax	Price	Qty per car	Part information
④	Connector	22672-RR710	B	3,675	3,500	1	Connector for direct connection with fuel delivery valve φ 8.0 pipe type, for 22670-RR710
	Hose	A8741-00039	—	—	—	1	Rubber hose for fuel line, internal diameter φ 7.5 L=1m Genuine Nissan part

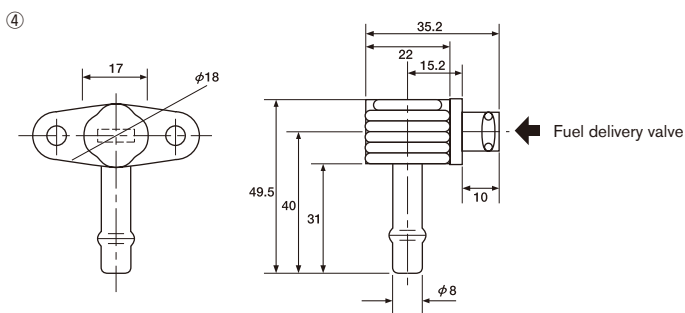

Connecting a general-purpose fuel pressure regulator

■ Connector

Install by removing the standard fuel pressure regulator

■ Fuel line

With rubber fuel line: Prepare rubber fuel line separately. Cut in accordance with the length needed to reach the regulator; attach.

With mesh fuel line: Prepare #6 mesh fuel line material separately. Cut in accordance with length required; attach using connector fittings.

■ Vacuum hose

Prepare 3mm internal diameter vacuum hose separately. Cut in accordance with the length needed to reach the regulator; attach.

■ Fuel pressure regulator

Whether reusing existing bolts or adding stays, attach in a position as close to the connector as possible, then attach fuel line and vacuum hose.

■ Return fuel line

With rubber fuel line: When the standard line length is too short, prepare rubber fuel line separately. Cut in accordance with the length needed to reach the regulator; attach.

With mesh fuel line : Prepare #6 mesh fuel line material separately. In accordance with the return line, attach using connector fittings.